



**xLED**

**xLED-7050 Pin Fin LED Heat Sink  $\Phi$ 70mm**

### Features VS Benefits

- \* Mechanical compatibility with direct mounting of the LED modules to the LED cooler and thermal performance matching the lumen packages.
  - \* Thermal resistance range Rth 2.6°C/W.
  - \* Modular design with mounting holes foreseen for direct mounting of a wide range of LED modules and COB's:
  - \* Diameter 70mm - Standard height 50mm , Other heights on request.
  - \* Forged from highly conductive aluminum.
- 2 standard colors - clear anodized - black anodized
- Zhaga Book 3 Spot Light Modules Edison , Osram ,Xicato ,Bridelux ,Citizen ,Cree , SHARP , Seoul , Philips , Tridonic , Vossloh-Schwabe , LG , Lustrous , Prolight , Luminus , Samsung .

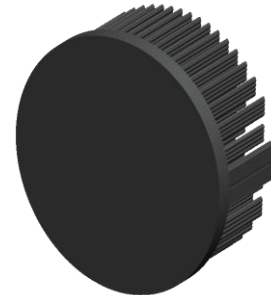

- 1) Xicato XSM, XIM,XTM;
- 2) Bridelux ES Star,Array V6,V8,V10 and Vero 10 Array LED engines;
- 3) Philips Fortimo SLM Modules.
- 4) Citizen CLL022-CLU024, CLL026-CLU028, CLL032-CLU034, CLL036-CLU038
- 5) Cree XLamp CXA13xx, CXA15xx;
- 6) SHARP Mini Zenigata LED engines;
- 7) Seoul Semiconductor ZC4, ZC6;
- 8) Tridonic TALEXXmodule SLE modules;
- 9) LG Innotek LEMWM18 10W, 13W;
- 10) Edison EdiLex SLM and EdiLex II COB LED engines;
- 11) Lustrous LUSTRON 6 series LL604F, LL608D, LL613F, LL620F;
- 12) Prolight Opto PABS, PABA, PACB, PANA;
- 13) Luminus CLM-9;CXM-9;CHM-9 COB LED engines;
- 14) Osram SOLERIQ P6,SOLERIQ S13 and PrevaLED Core LED engines;
- 15) Vossloh-Schwabe LUGA Shop and LUGA C LED engines;
- 16) Samsung LC013 LED engines;

### Order Information

Example:xLED-7050-B-#

Example:xLED-7050 - **1**

- 1** Anodising Color
- B-Black
- C-Clear
- Z-Custom



MingFa recommends the use of a high Thermal conductive interface between the LED Module and the LED cooler. Either thermal grease, A thermal pad or a phase change thermal pad Thickness 0.1-0.15mm is recommended.

The thermal data table

	
	<i>xLED-7050</i>
<b>Model No.</b>	<b>xLED-7050</b>
<b>Size</b>	<b><math>\Phi</math>70xH50mm</b>
<b>Material</b>	<b>AL1070</b>
<b>Finish</b>	<b>Black Anodized</b>
<b>Weight(g)</b>	<b>150</b>
<b>Thermal Wattage</b>	<b>19.5W</b>
<b>Heatsink<math>\Theta</math>s-a<sup>2</sup></b>	<b>91577</b>
<b>Heat Sink Rise<sub>T</sub> Rise Above Ambient (<math>^{\circ}</math>C/W)</b>	<b>2.56</b>

Dissipated Power Pd(W)	Pd = Pe x (1- $\eta$ L)	Heat sink to ambient thermal resistance Rhs-amb ( $^{\circ}$ C/W)	Heat sink to ambient temperature rise Ths-amb ( $^{\circ}$ C)
		xLED-7050	
4.0		3.0	12.0
8.0		2.9	23.0
12.0		2.8	34.0
16.0		2.7	43.0
20.0		2.6	51.0

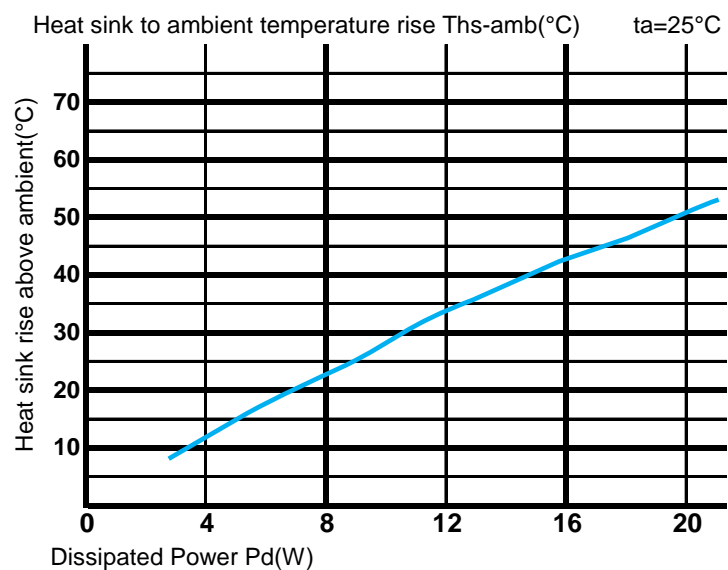

Notes:

- Mentioned models are an extraction of full product range.
- For specific mechanical adaptations please contact MingfaTech.
- MingfaTech reserves the right to change products or specifications without prior notice.