

# SPECIFICATION

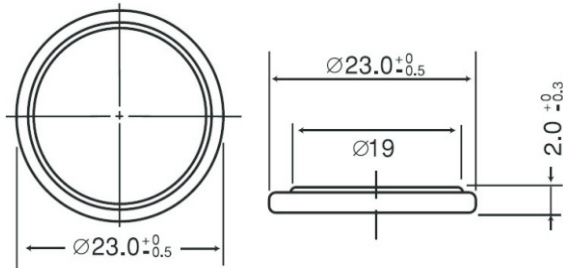

CR2320 3.0V

## Electrical characteristics

(Typical values relative to cells stored for one year at +30°C max)

<p>○ <b>Nominal capacity</b> Discharged capacity at 0.2mA, +25°C, 2.0V cut off</p>	150mAh
<p>○ <b>Nominal voltage</b></p>	3.0V
<p>○ <b>Max. recommended continuous current</b> Discharged to 2.0V at +25°C permitting 50% of the nominal capacity to be achieved</p>	6mA
<p>○ <b>Max. Pulse capability</b> Current value is obtained when pulse is applied for 15 seconds at 50% discharge depth at 25°C</p>	25mA
<p>○ <b>Operating temperature range</b></p>	-30°C ~ +60°C
<p>○ <b>Weight (approx.)</b></p>	3.0g

## Key features

- High and stable operating voltage
- Low self-discharge rate
- Annual self-discharge rate lower than 2% at +20°C
- High energy density
- Glass to metal seal
- Compliant with IEC 86-4 safety standard
- Non-restricted for transport

UL Component Recognition  
File Number MH46165

## Main applications

- Alarms or security equipment
- Smoke detectors
- Memory backup
- Real time clock
- Portable computers
- Electronic equipment (watches, calculators, etc.)
- Medical equipment
- .....

Discharge characteristics at 25°C

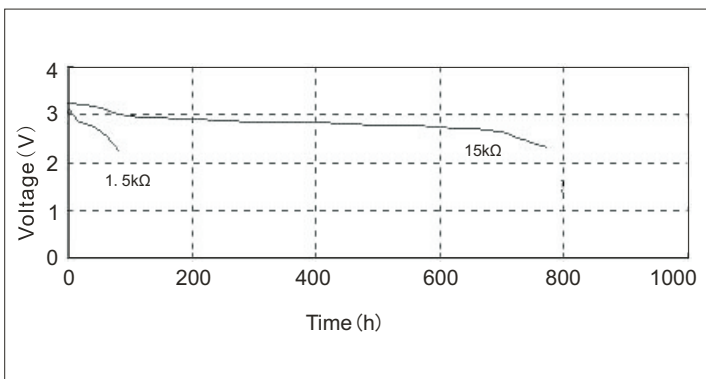

Discharge curve in different temperatures (15kΩ)

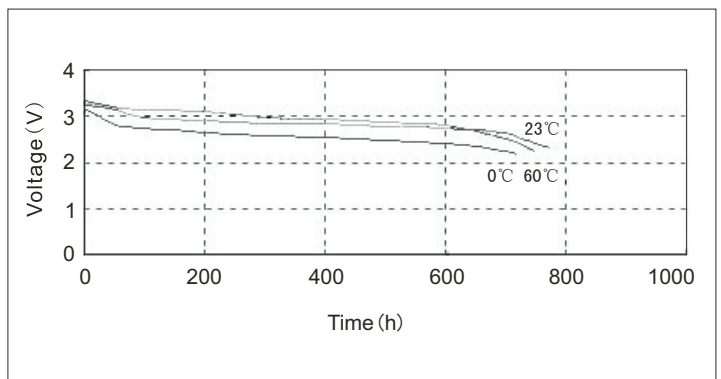

## STORAGE:

Stored in clean, dry and cool circumstances (the temperature should be 20 degrees or lower, less than 30 degrees)

## WARNING:

Don't charge, crush, disassemble, expose contents to water, heat above 100°C or may lead to explosion, burn or poison goods leakage. Discarded battery should be buried deeply to the ground.