



for

LED



eLED

eLED-9580 Modular Passive LED Star Heat Sink Φ 95mm

Features VS Benefits

- * Mechanical compatibility with direct mounting of the LED modules to the LED cooler and thermal performance matching the lumen packages.
 - * Thermal resistance range Rth 1.1°C/W.
 - * Modular design with mounting holes foreseen for direct mounting of a wide range of LED modules and COB's:
 - * Diameter 95mm - Standard height 80mm , Other heights on request.
 - * Extruded from highly conductive aluminum.
- 2 standard colors - clear anodised - black anodised
- Zhaga Book 3 Spot Light Modules Edison , Osram , Xicato ,Bridgelux , Citizen , Cree , Lumileds ,Tridonic Vossloh-Schwabe , LG Innotek, Seoul , Luminus ,Prolight ,SHARP ,Samsung , Lustrous .Philips

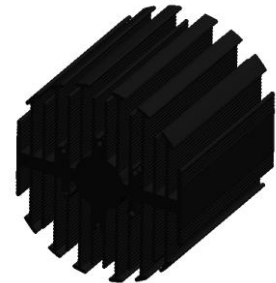

- 1) Xicato XSM, XIM,XTM;(XSA-309;XSA-310)
- 2) Bridgelux ESS, ESR, Vero 10, Vero 13,Vero 18,Vero 29 V-series;
- 3) Citizen CLL022-CLU024, CLL032-CLU034,CLL040-CLU044;
- 4) Cree XLamp CXA13xx, CXA15xx,CXA18,CXA25;
- 5) Lumileds Luxeon COB's 1203, 1204, 1205, Luxeon K arrays K12, K16;
- 6) LG Innotek LEMWM18 27W, 24W, 40W;
- 7) Seoul Semiconductor ZC25, ZC40,ZC60, ZC100 Series;
- 8) Tridonic TALEXXmodule SLE Modules engines;
- 9) Luminus C##14 ,C##22COB LED engines.
- 10) Edison EdiLex SLM and EdiLex II COB LED engines;
- 11) Prolight Opto PABS, PABA, PACB, PANA;
- 12) SHARP Tiger Zenigataand and Mega Zenigata LED engines;
- 13) Samung COB LC026B,LC033B,LC040BCOB LED engines;
- 14) Vossloh-Schwabe Vossloh-Schwabe LUGA Shop LED engines;
- 15) OSRAM PrevaLED Core,SOLERIQ P,SOLERIQ E and SOLERIQ S LED engines;
- 16) Lustrous M series, LUSTRON series, Coral series,LUSTRON 5 6 series LED engines;
- 17) Philips Fortimo SLM LED engines.



Order Information

Example:eLED-9580-B-#

Example:eLED-95 **1** - **2**

- 1** Hight (mm)
- 2** Anodising Color
 - B-Black
 - C-Clear
 - Z-Custom

MingFa recommends the use of a high thermal conductive interface between the LED module and the LED cooler. Either thermal grease, a thermal pad or a phase change thermal pad thickness 0.1-0.15mm is recommended.

The thermal data table

| | |
|---|--|
| |  <i>eLED-9580</i> |
| Model No. | eLED-9580 |
| Size | Φ 95x80mm |
| Material | AL6063-T5 |
| Finish | Black Anodized |
| Weight(gr) | 564 |
| Thermal Wattage | 49.2W |
| Heatsink Θs-a² | 170178 |
| Heat Sink Rise T_{Rise Above Ambient} (°C/W) | 1.1 |

| Dissipated Power Pd(W) | Pd = Pe x (1-ηL) | Heat sink to ambient thermal resistance Rhs-amb (°C/W) | Heat sink to ambient temperature rise T _{hs-amb} (°C) |
|------------------------|------------------|--|--|
| | | eLED-9580 | |
| 10 | | 1.6 | 16 |
| 20 | | 1.3 | 26 |
| 30 | | 1.2 | 35 |
| 40 | | 1.1 | 44 |
| 50 | | 1.0 | 52 |

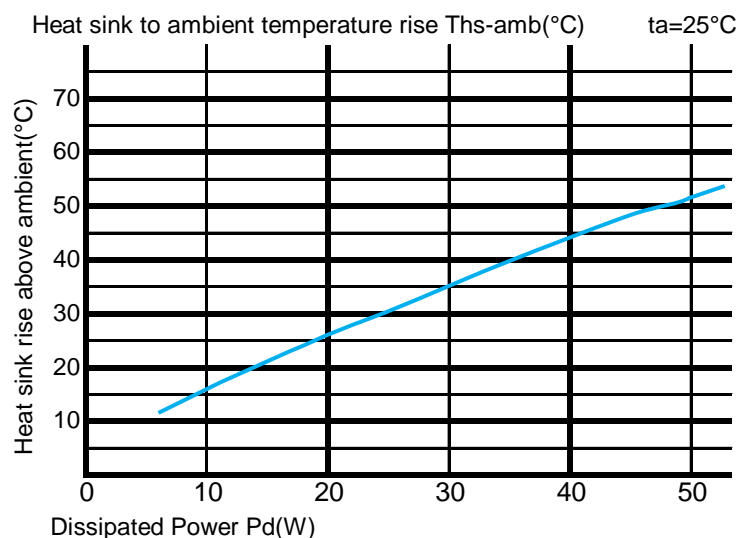

Notes:

- Mentioned models are an extraction of full product range.
- For specific mechanical adaptations please contact MingfaTech.
- MingfaTech reserves the right to change products or specifications without prior notice.