

EtraLED

EtraLED-PHI-8520 - Philips Modular Passive Star LED Heat Sink Φ 85mm

Features VS Benefits

- * The EtraLED-PHI-8520 Philips Modular Passive Star LED Heat Sinks are specifically designed for luminaires using the Philips LED engines.
- * Mechanical compatibility with direct mounting of the LED engines to the LED cooler and thermal performance matching the lumen packages.
- * For spotlight and downlight designs from 700 to 2800 lumen.
- * Thermal resistance range R_{th} 2.0°C/W.
- * Modular design with mounting holes foreseen for direct mounting of Philips SLM engines.
- * Diameter 85mm - standard height 20mm Other heights on request.
- * Extruded from highly conductive aluminum.

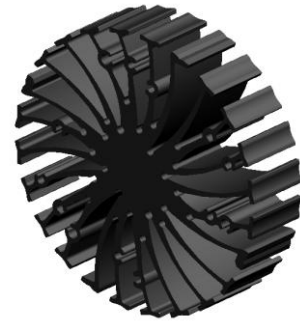

Zhaga LED engine and radiator assembly is a unified future international standardization

- * Below you find an overview of Philips COB's and LED modules which standard fit on the EtraLED Star LED Heat Sinks.
- * In this way mechanical after work and related costs can be avoided, and lighting designers can standardize their designs on a limited number of Star LED Heat Sinks.

PHILIPS

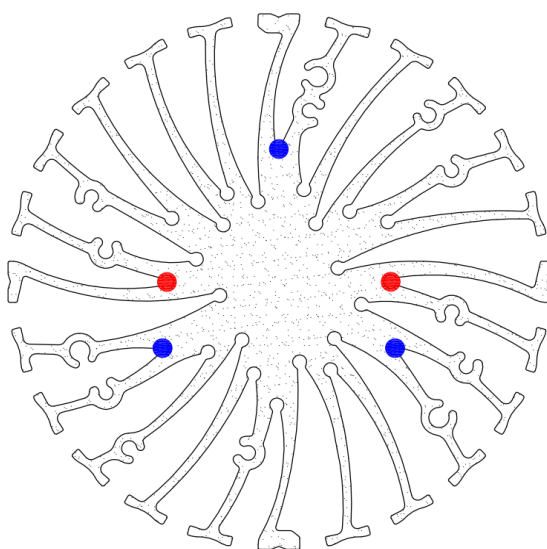

Philips LED engines for which Zhaga LED Modules holders are available.

For the Fortimo SLM LED engines.

Philips Fortimo SLM LED modular Gen4:

Fortimo LED SLM 1100LM 827 L9 G4;
 Fortimo LED SLM 1100LM 830 L9 G4;
 Fortimo LED SLM 1100LM 840 L9 G4;
 Fortimo LED SLM 1100LM 827 L13 G4;
 Fortimo LED SLM 1100LM 830 L13 G4;
 Fortimo LED SLM 1100LM 840 L13 G4;
 Fortimo LED SLM 2000LM 830 L13 G4;
 Fortimo LED SLM 2000LM 840 L13 G4;
 Fortimo LED SLM 2000LM 927 L13 G4;
 Fortimo LED SLM 2000LM 930 L13 G4;

Philips Fortimo SLM LED modular Gen3:

Fortimo LED SLM 2000LM 830 L19 G3;
 Fortimo LED SLM 2000LM 840 L19 G3;
 Fortimo LED SLM 2000LM 930 L19 G3;

Philips Fortimo SLM LED modular Gen2:

Fortimo LED SLM 800LM 827 L13 G2;
 Fortimo LED SLM 800LM 830 L13 G2;
 Fortimo LED SLM 800LM 835 L13 G2;
 Fortimo LED SLM 800LM 840 L13 G2;
 Fortimo LED SLM 800LM 927 L13 G2;
 Fortimo LED SLM 800LM 930 L13 G2;
 Fortimo LED SLM 1100LM 827 L13 G2;
 Fortimo LED SLM 1100LM 830 L13 G2;
 Fortimo LED SLM 1100LM 835 L13 G2;
 Fortimo LED SLM 1100LM 840 L13 G2;
 Fortimo LED SLM 1100LM 927 L13 G2;
 Fortimo LED SLM 1100LM 930 L13 G2;

NO'1:Zhaga Book3 Red indicator marks:
 Direct mounting with machine screws M3x8mm;
 NO'2: Blue indicator marks.
 Direct mounting with machine screws M3x8mm;

Mounting Options and Drawings & Dimensions

Example: EtraLED-PHI-8520-B-3

Example: EtraLED-PHI-85 **1** - **2** - **3**

- 1** Height (mm)
- 2** Anodising Color
 - B-Black
 - C-Clear
 - Z-Custom
- 3** Mounting Options - see graphics for details Combinations available
Ex.order code - 12 means option 1 and 2 combined

Notes:

- Mentioned models are an extraction of full product range.
- For specific mechanical adaptations please contact MingfaTech.
- MingfaTech reserves the right to change products or specifications without prior notice.



MOUNTING OPTION	Module type	Holder NO.	THREAD	THREAD DEPTH	THREAD HOLE DISTANCE
1	Fortimo SLM	/	M3	8mm	35.0mm/ 2-@180°
2		/	M3	8mm	42.0mm/ @3-120°

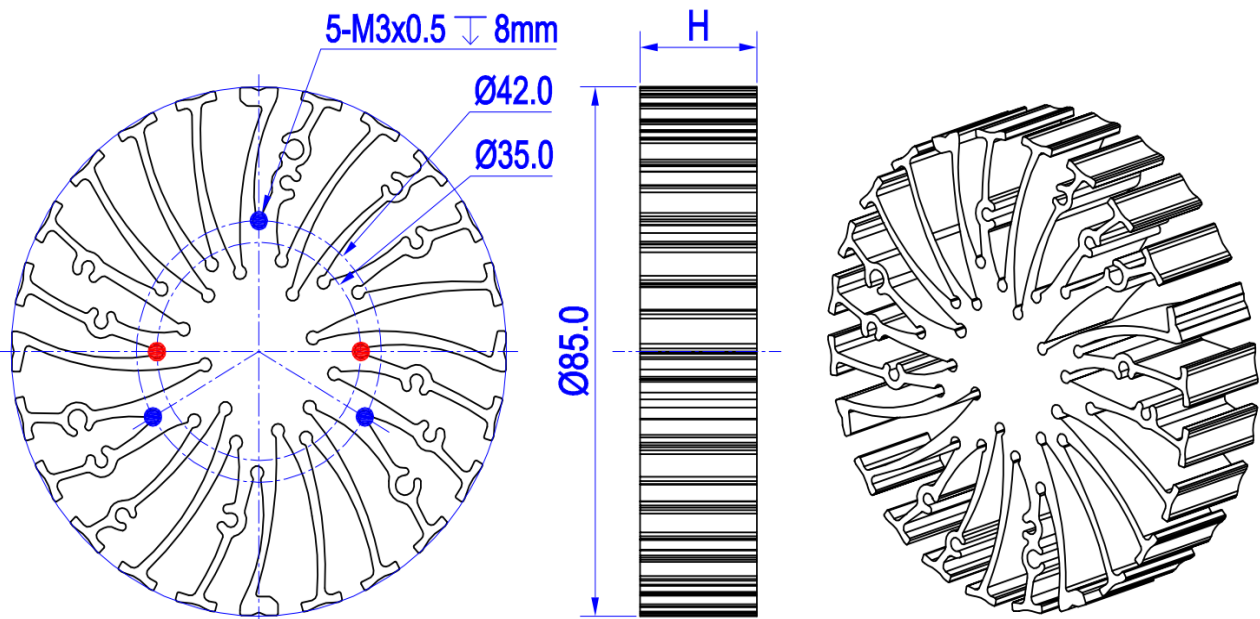

EtraLED

EtraLED-PHI-8520 - Philips Modular Passive Star LED Heat Sink Φ85mm

The thermal data table

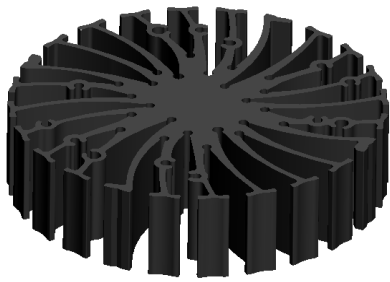
	 <i>EtraLED-8520</i>
Model No.	EtraLED-PHI-8520
Size	Φ85xH20mm
Material	AL6063-T5
Finish	Black Anodized
Weight(gr)	115.0
Thermal Wattage	25.0W
HeatsinkΘs-a²	40076
Heat Sink T_{Rise} Above Ambient	2.0

Dissipated Power Pd(W)	Pd = Pe x (1-ηL)	Heat sink to ambient thermal resistance Rhs-amb (°C/W)	Heat sink to ambient temperature rise Ths-amb (°C)
		EtraLED-PHI-8520	EtraLED-PHI-8520
6		2.7	16
12		1.8	22
18		2.1	37
24		2.0	48
30		1.9	57

